

LEVEL 1 - FLOOR PLAN
SCALE: 1/8" = 1'-0"

MATERIALS KEYING LEGEND

KEYNOTE NO.	KEYNOTE DESCRIPTION
104413.FSR	SEMI-RECESSED FIRE EXT. CABINET

KEY NOTES

- 1 CHEMICAL HOOD (PASS THROUGH) PER MECHANICAL
- 2 CHEMICAL STORAGE OFCI - TALL CABINET
- 3 CHEMICAL STORAGE AS OFCI - CABINET
- 4 ICE MACHINE
- 5 ELECTRICAL FLOOR J BOX - COORDINATE LOCATION WITH ELECTRICAL & STRUCTURAL DRAWINGS
- 6 ADA LAB STATION WITH ADA SINK AND FAUCET
- 7 SINK MOUNTED EYE WASH STATION - PER PLUMBING
- 8 RECESSED / WALL MOUNTED EYE WASH & SHOWER STATION PER PLUMBING
- 9 MECHANICAL OR ELECTRICAL EQUIPMENT PER OTHER SERIES SHEETS
- 10 SEE "FP" SERIES SHEETS FOR FIRE RISER EQUIPMENT
- 11 24" x 24" MECHANICAL & PLUMBING FLOOR BOX FOR FUTURE TEACHER STATION, SEE STRL FOR SLAB DETAILS - SEE MECH & PLUMB
- 12 PROVIDE MOISTURE RESISTANT GWB AT EYE WASH / SHOWER WALL PER SPECIFICATION SECTION 092900.
- 13

GENERAL NOTES

1. SEE OTHER W SERIES SHEETS FOR ADDITIONAL INFORMATION WHERE APPLICABLE.
2. SEE MECH, ELECTRICAL, STRUCTURAL, AND OTHER SYSTEMS DRAWINGS FOR INFORMATION NOT INDICATED ON THIS SHEET.
3. ALL DIMENSIONS ARE TO FACE OF BRICK, CENTERLINE OF FRAMING / STRUCTURE, UNLESS NOTED OTHERWISE
4. ALL DOOR ROUGH OPENINGS SHALL BE LOCATED 5' OFF THE ADJACENT STUD WALL OR CENTERED IN THE WALL, UNLESS NOTED OTHERWISE
5. CONTRACTOR TO COORDINATE ROUGH OPENINGS FOR WINDOWS AND DOORS WITH WINDOW/DOOR MANUFACTURER

WALL LEGEND

- SEE WALL TYPES & FLOOR PLANS FOR SIZES AND DIMENSIONS OF WALLS.
- ALL WALLS EXTEND TO UNDERSIDE OF ROOF JOIST/TRUSSES ABOVE UNLESS INDICATED OTHERWISE. IF ACOUSTIC INSULATION IS SHOWN, IT SHALL EXTEND FULL HEIGHT OF WALL.
- SEE STRUCTURAL FOR TOP OF WALL CONNECTIONS.
- SEE A10 SERIES FOR ASSEMBLY DESCRIPTION
- USE WALL TYPE WW6.A FOR WALLS NOT OTHERWISE NOTED
- WALL TYPES APPLY FOR TOTAL LENGTH OF WALL UNLESS NOTED OTHERWISE

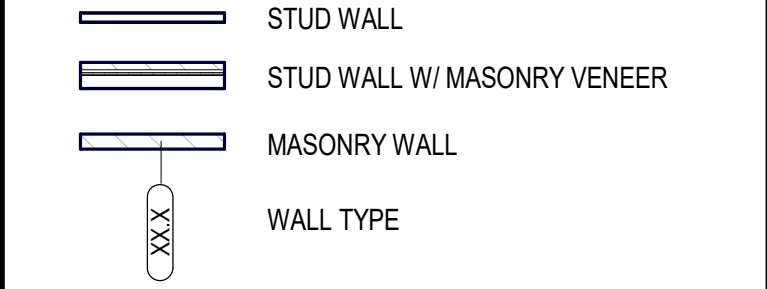

KEY PLAN

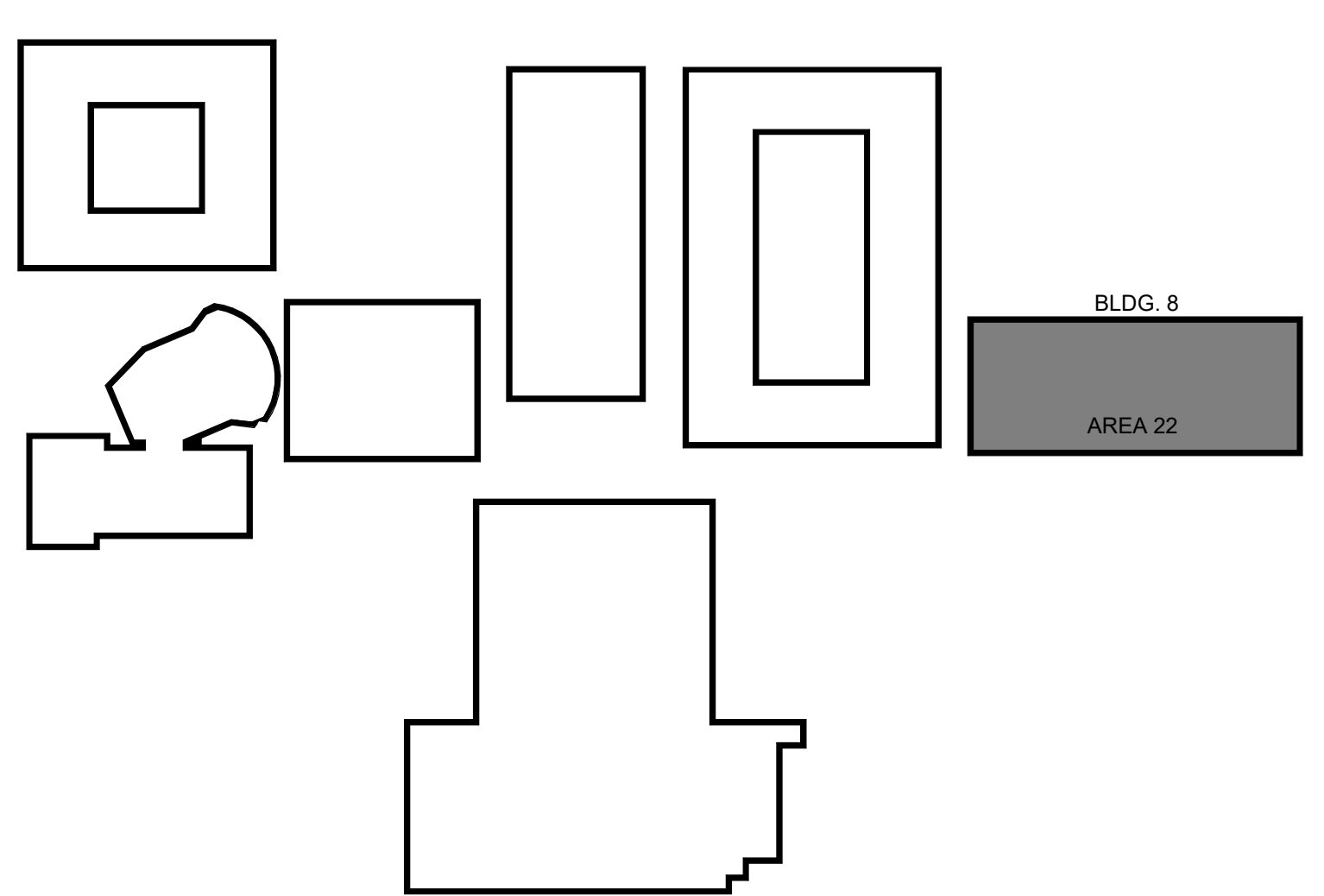

Copyright 2019
All rights reserved. Reproduction or translation of any part of this work without written permission of ARCHITECTS WEST, INC. is a violation and subject to criminal prosecution.

Architects West
210 E Lakeside Ave
Coeur d'Alene, ID 83814
t. 208.667.9402
architectswest.com

- ARCHITECT OF RECORD
ARCHITECTS WEST
210 EAST LAKESIDE AVE
COEUR D'ALENE, ID 83814
(208) 667-9402
- LANDSCAPE ARCHITECT
ARCHITECTS WEST
1710 EAST LAKESIDE AVE
COEUR D'ALENE, ID 83814
(208) 667-9402
- STRUCTURAL ENGINEER
LSB CONSULTING ENGINEERS
100 N. WASHINGTON, STE. 505
SPOKANE, WA 99202
(509) 322-9292
- MECHANICAL ENGINEER
MSI ENGINEERS
100 N. WASHINGTON, STE. 505
SPOKANE, WA 99201
(509) 624-1950
- ELECTRICAL ENGINEER
COMLEY ENGINEERING
P.O. BOX 6126
SPOKANE, WA 99202
(509) 965-9872
- FIRE PROTECTION ENGINEER
FP ENGINEERING
S. 4423 TAMPA DRIVE
SPOKANE, WA 99223
(509) 448-1976
- CIVIL ENGINEER
PBS
11207H COLVILLE ST., SUITE 200
WALLA WALLA, WA 99262
(509) 856-3020

WALLA WALLA PUBLIC SCHOOLS
HIGH SCHOOL - BLDG 8 - NEW SCIENCE BUILDING
800 ABBOTT ROAD, WALLA WALLA, WA
LEVEL 1 - FLOOR PLAN

PROJECT NO.	1888
DESIGNED BY	KWC
DRAWN BY	AMRF
ISSUE DATE	10.04.2019
PHASE	ADD POSTED
CHECKED BY	JS
REVISION	ADD 2: 09.13.19
SHEET NO.	

A2.01